

rotowash cleaning instructions

- o Make sure machine is switched off and unplugged from the mains
- o Holding waste water tray from rear, lift slightly, pull back and empty – do not touch stripper blade



Stripper
Blade

- o Turn back brush towards you to rotate drum – wipe drum
- o Remove back brush by pushing axle on one side, and pulling out the other

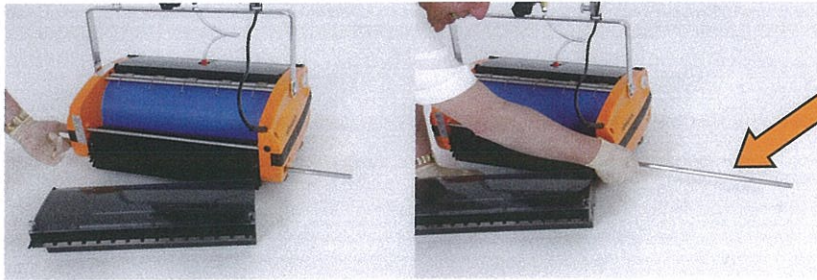

Axle

- o Remove brush

- o Wipe inside the machine

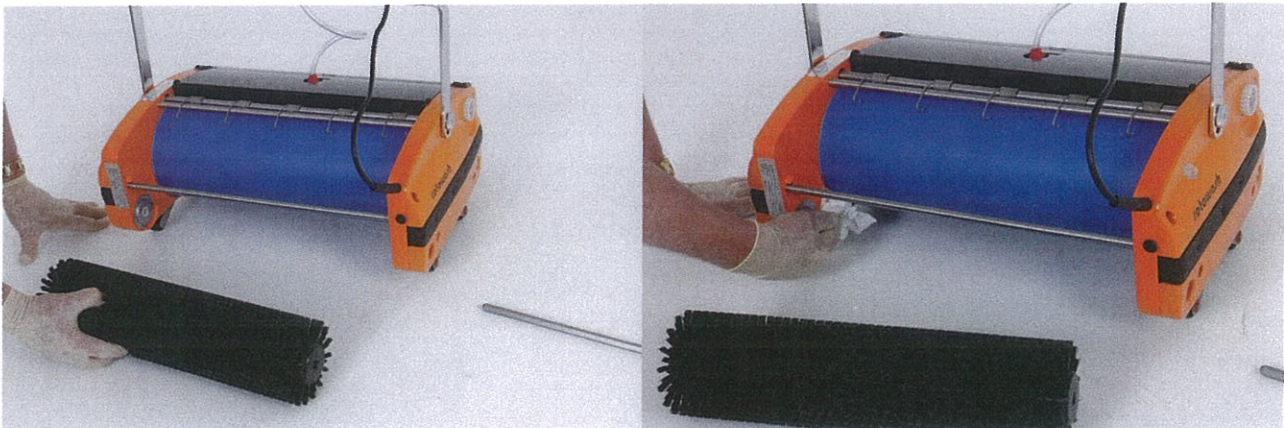

PTO

rotowash



- o Wash brush, then place on brush guides.



- o Replace axle from the side with the cable, rotate, push in until centralised

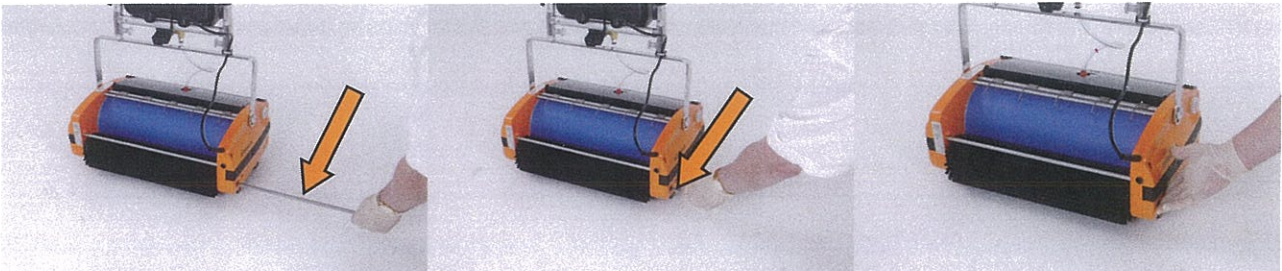

- o At front of machine, remove clean tray or pump, wipe underneath, set aside

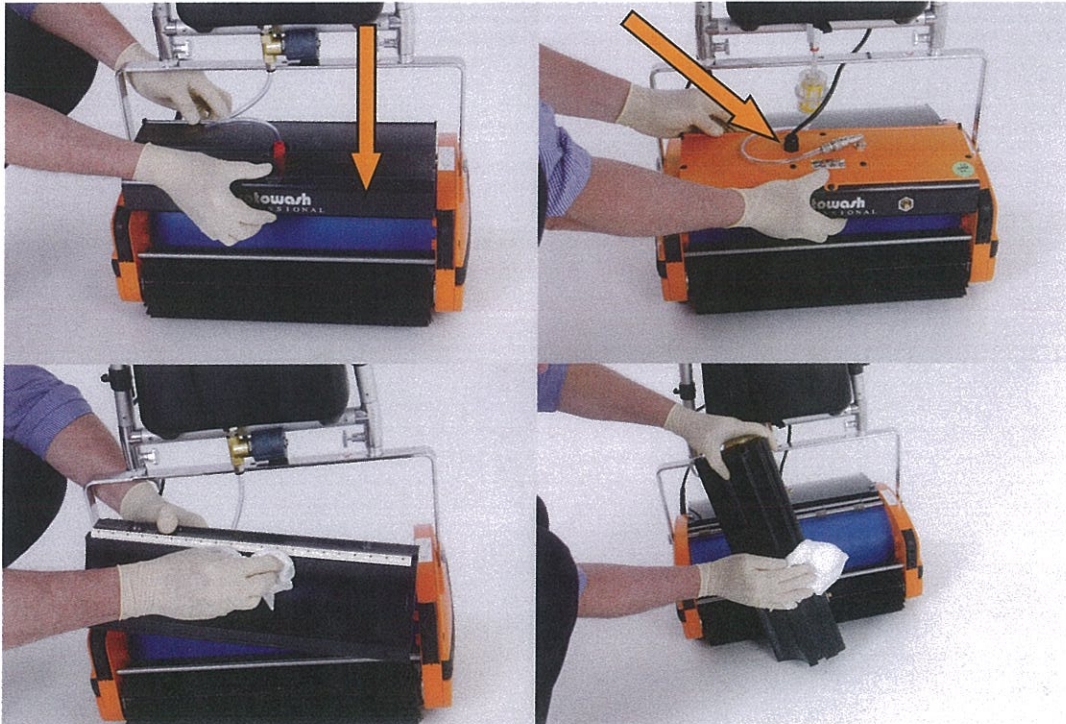

- o Remove front brush, clean and replace as above
- o Replace clean tray/pump
- o For free operator training, or for answers to any queries, call

rotowash on **020 8847 4545**



ISO 9001 / BS 5750 Part 2 - Certificate No. 5020

Rotowash Ltd.,
7 Victory Business Centre, Fleming Way, Isleworth, Middlesex TW7 6DB
Tel: 020 8847 4545 E-Mail: cleanfloors@rotowash.com
Fax: 020 8569 7906 Website: www.rotowash.com
Vat Reg. No. 906 9158 06 Company Reg. No. 06160994